

Torsion Spring Suspension System Installation Instructions

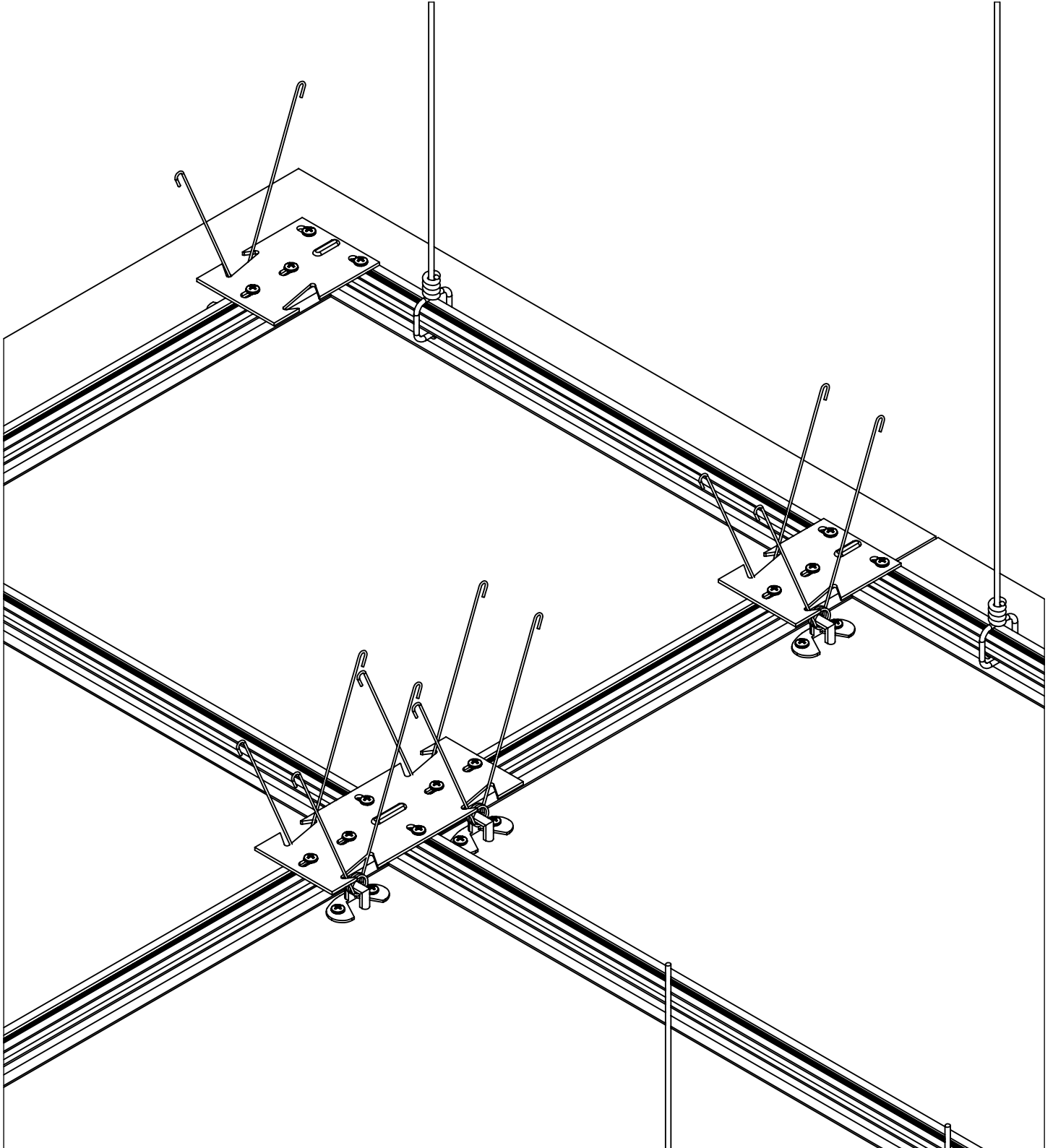

Torsion Spring Custom
Typical Panel Details featuring Individual Panel
Downward Accessibility

MCM
ACOUSTICAL

MCM Acoustical | 6860 Rexwood Road
Mississauga | Ontario | Canada | L4V 1L8
T: 905.670.3733 | F: 416.665.9419
E: info@mcmacoustical.com | WEB: www.mcmacoustical.com

Torsion Spring Suspension Installation Instructions

1. Check all required components supplied loose by MCM Acoustical against Component List.
2. Comomnly Used Components:

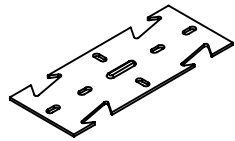

MCMA-C1

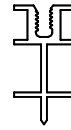

Main "M" Grid

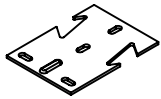

MCMA-C2

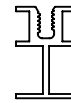

Cross "C" Grid



MCMA-C3



Torsion Spring

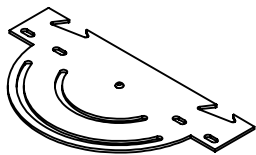

MCMA-C4

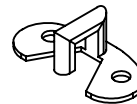

Spring Holder

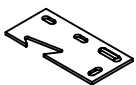

MCMA-C5

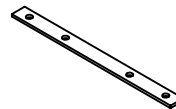

Joint Plate

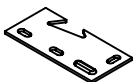

MCMA-C6



Metal Tapping
Screw #10x3/8"
FOR CLIP

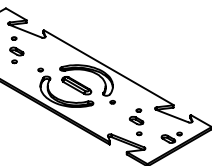

MCMA-C7



Wood Screw
#8x1/2"
FOR SPRING HOLDER



Metal Tapping
Screw #8x1/2"
FOR JOINT PLATE

MCM
ACOUSTICAL

MCM Acoustical | 6860 Rexwood Road
Mississauga | Ontario | Canada | L4V 1L8
T: 905.670.3733 | F: 416.665.9419
E: info@mcmacoustical.com | WEB: www.mcmacoustical.com

Torsion Spring Suspension Installation Instructions

3. Review installation drawings (grid Layout and Panel Layout)

Panel Layout With Tagging

C1	C2	C3
B1	B2	B3
A1	A2	A3

Grid Layout

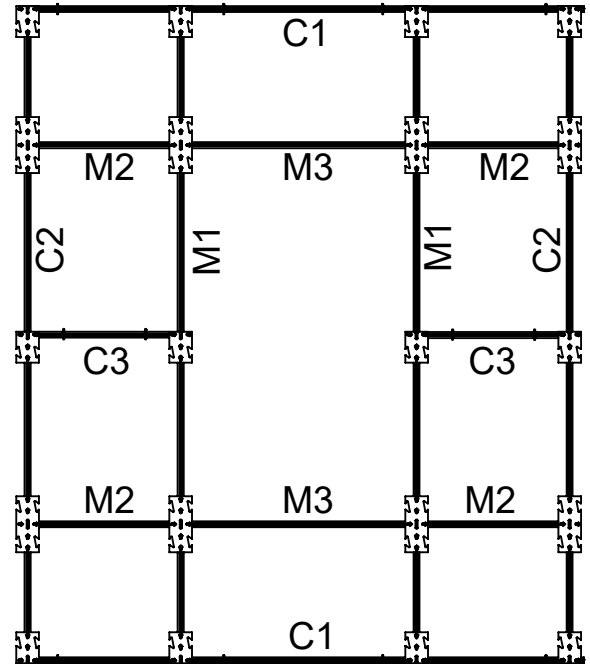

Note:

Grid layout shown above is typical for panel sizes 30" (762mm) x 60" (1524mm) X 5/8" (16mm) thick. For panels exceeding these sizes, additional grid cross members, clips, and torsion springs will be required. Grid will be spaced nominally on 24" (610mm) centers. Please contact MCM Acoustical for any project specific questions that you may have.

MCM
ACOUSTICAL

MCM Acoustical | 6860 Rexwood Road
Mississauga | Ontario | Canada | L4V 1L8
T: 905.670.3733 | F: 416.665.9419
E: info@mcmacoustical.com | WEB: www.mcmacoustical.com

Torsion Spring Suspension Installation Instructions

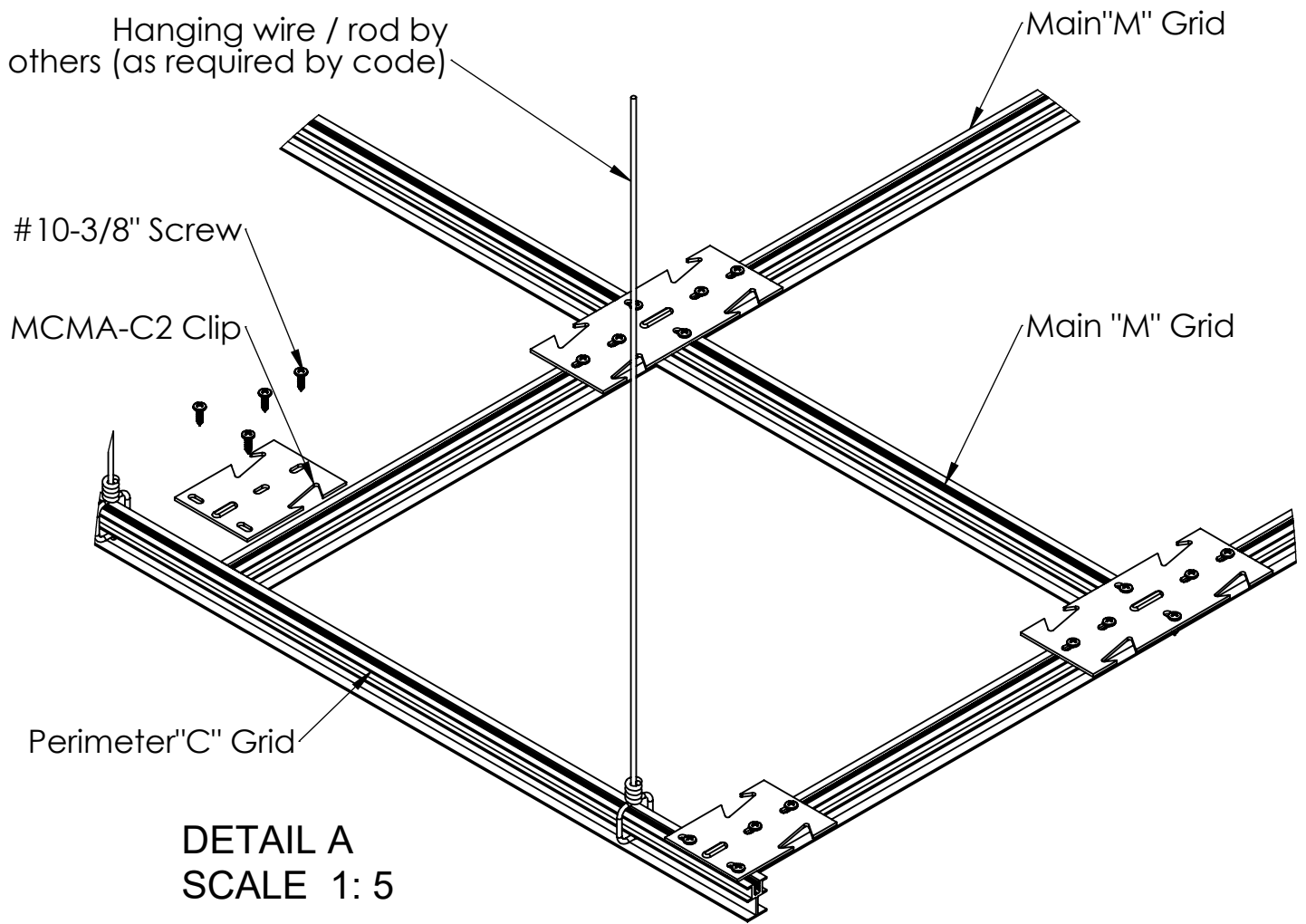

Exploded Perspective @ MCMA Clip (Typical)

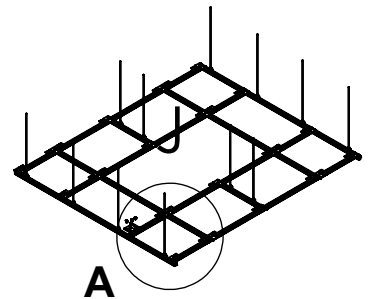

MCM Acoustical | 6860 Rexwood Road
Mississauga | Ontario | Canada | L4V 1L8

T: 905.670.3733 | F: 416.665.9419
E: info@mcmacoustical.com | WEB: www.mcmacoustical.com

Torsion Spring Suspension Installation Instructions

- Lay down grid and clip components on the floor or other level surface, accurately locate and attach the clips (top up) to the long grid members using the #10-3/8" Metal Tapping Screws. Ensure that the orientation of clips matches the provided project drawings. Attach all joint plates as required using Metal Tapping screws #8x1/2".

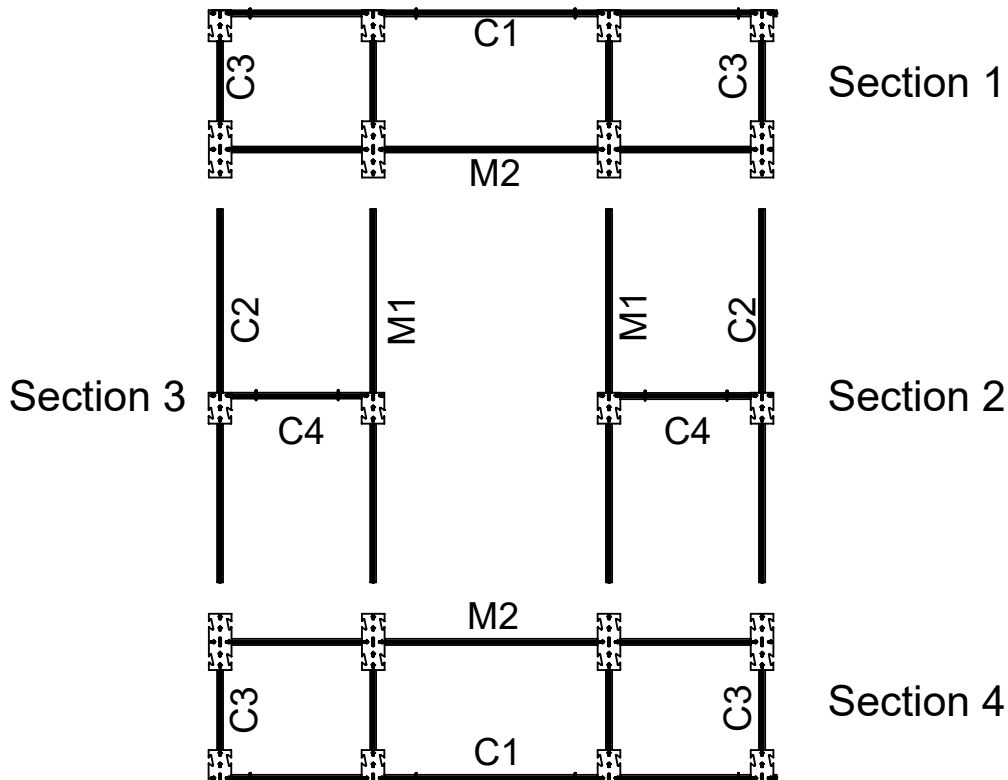

- Assemble pairs or sections of grid.
- Hang the assembled "Sections" in their final ceiling locations. It is best to handle workable sizes and fasten these members in place by fastening to existing clips.

MCM
ACOUSTICAL

MCM Acoustical | 6860 Rexwood Road
Mississauga | Ontario | Canada | L4V 1L8
T: 905.670.3733 | F: 416.665.9419
E: info@mcmacoustical.com | WEB: www.mcmacoustical.com

Torsion Spring Suspension Installation Instructions



7. Insert Torsion Spring Into Spring Holder.

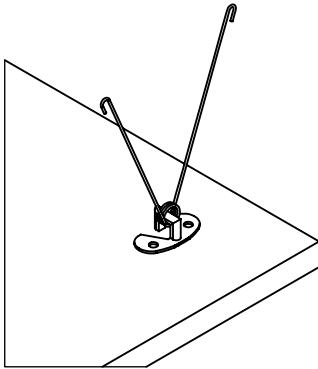

8. Screw The Spring Holder To The Back Face of The Wood Ceiling Panel in The Pre-drilled Pilot Holes. Make Sure To Use The #8 x 3/8" Metal Tapping Screws Provided.

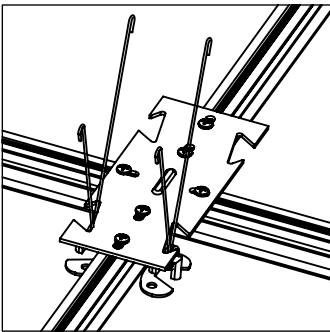

9. Locate The Spring Holder Torsion Spring Assembly on The Interior Rear Surface of The Wood Ceiling Panel With The Centre of The Spring Receiver Aligned With The Clip.

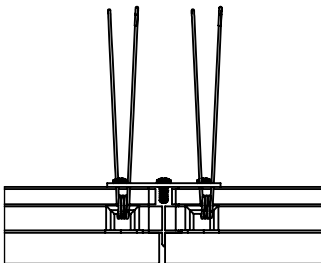

10. When Installing The Ceiling Panels Engage Springs Into The Clips. When All Springs on a Panel are Engaged Push The Panel Up To Secure.

MCM

A C O U S T I C A L

MCM Acoustical | 6860 Rexwood Road
Mississauga | Ontario | Canada | L4V 1L8

T: 905.670.3733 | F: 416.665.9419
E: info@mcmacoustical.com | WEB: www.mcmacoustical.com

Torsion Spring Suspension Installation

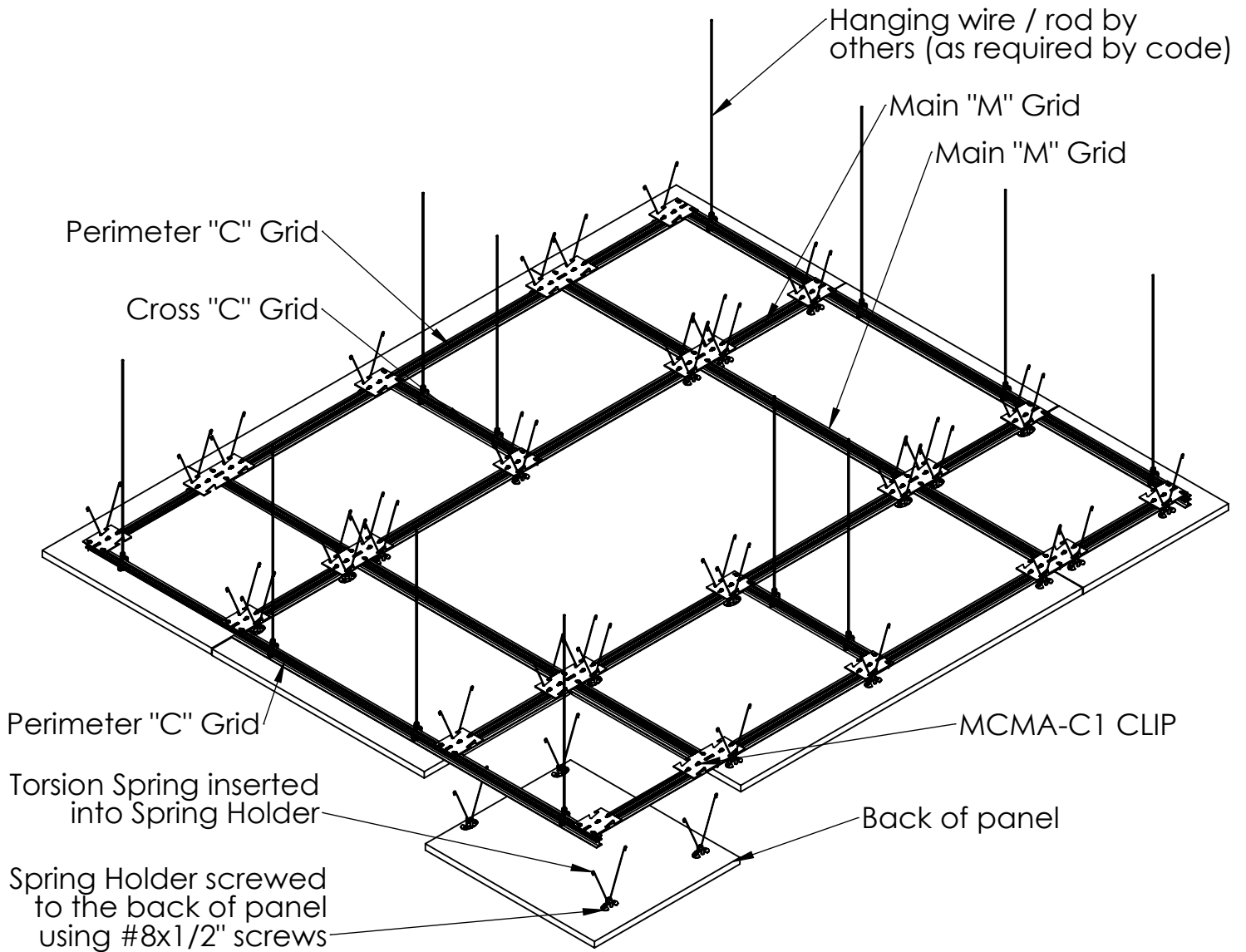

Perspective View - Back of Ceiling Assembly to Grid

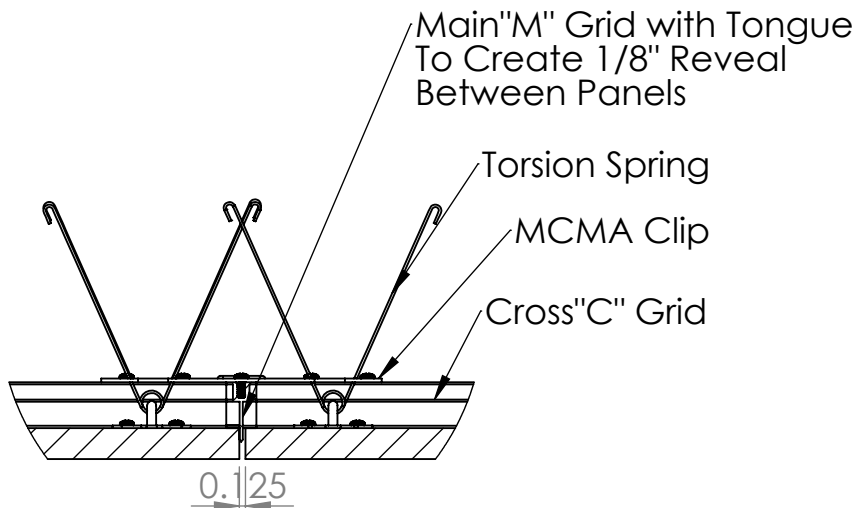

DETAIL BETWEEN PANELS

MCM
ACOUSTICAL

MCM Acoustical | 6860 Rexwood Road
Mississauga | Ontario | Canada | L4V 1L8

T: 905.670.3733 | F: 416.665.9419
E: info@mcmacoustical.com | WEB: www.mcmacoustical.com